

# Confirming PDF Files

All PDF outlines on this website are available for you to print and check against your original part or to cut out with a pair of scissors and lay on the guitar to see if the template we have on file will work for your particular application.

PDF outlines of pick guards are all set up at 100% scale with all components in the exact position that they would be cut in the final part. Outlines can be large so many are set up on an 11" x 17" Tabloid sheet of paper which may require you take the PDF to a copy service bureau like Kinko's to get them printed.

You will not be able to tell if the outline is accurate simply by looking at it or holding it over the guitar. You will need to remove your original pick guard and lay it on the printed PDF outline for the most accurate results.

It is very important to be sure you print the PDF outlines at 100% scale. There are some basic printer dialogue settings that you may need to set to ensure that the outline prints at 100% scale.

The image below is a screen capture of a common printer dialogue box to give you an idea where to look for the setting.

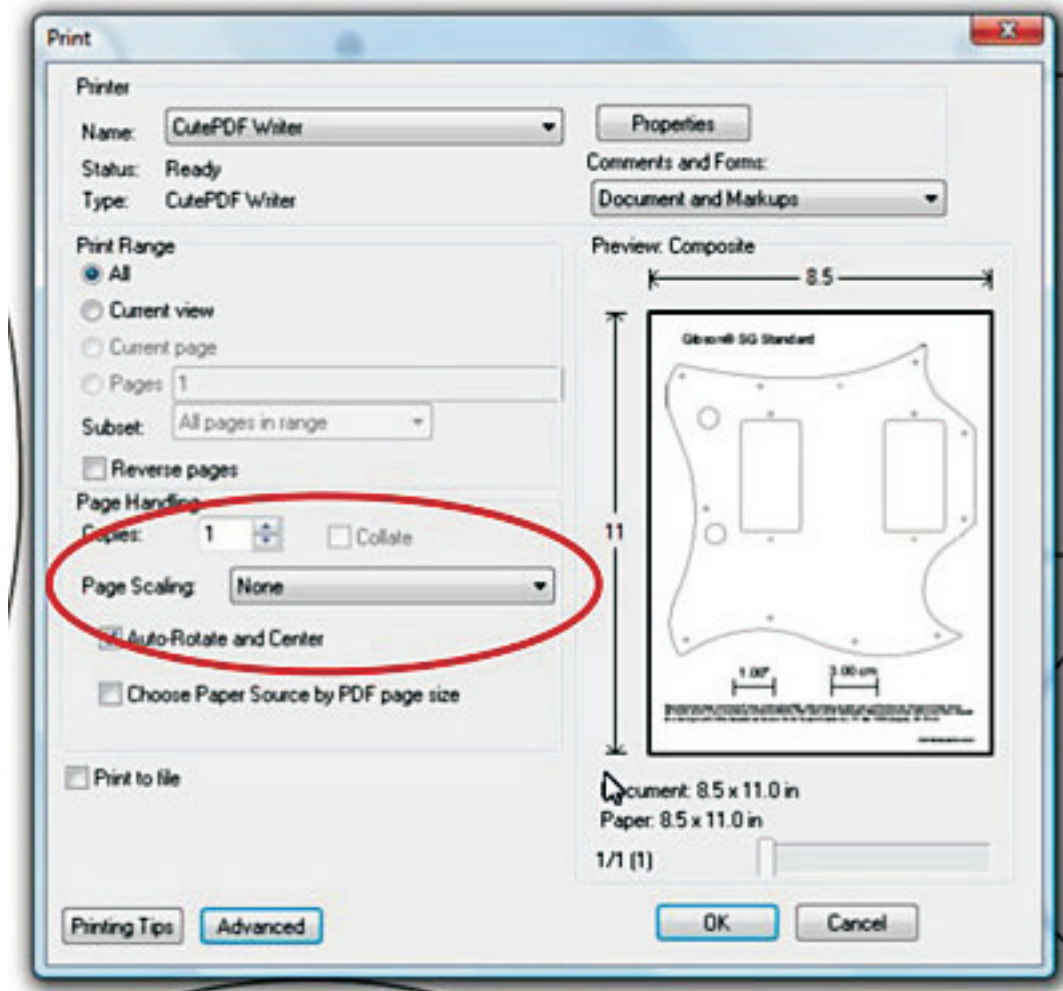

Website: [www.terrappinguitars.com](http://www.terrappinguitars.com)  
E-mail: [info@terrappinguitars.com](mailto:info@terrappinguitars.com)